

## 水泥工业链 Cement Industrial Chains

### 鳞(裙)板机链 Apron Chains

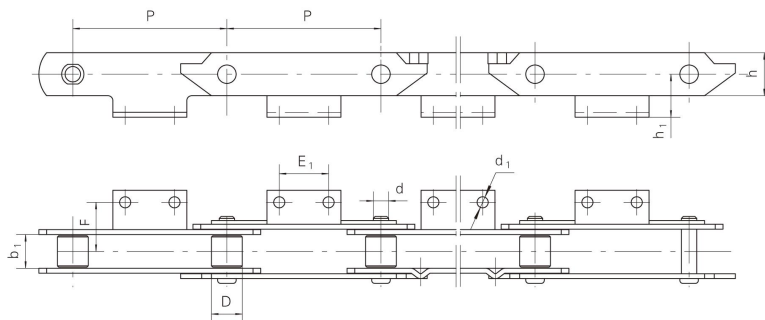

链号	节距	内节内宽	滚子外径	销轴	链板	最小抗拉强度
Chain No.	Pitch	Width between inner Sidebars	Roller Diameter	Pin	Sidebar	Ultimate Tensile Strength
	P	b <sub>1</sub> ( min )	D ( max )	d	h	F <sub>u</sub> (min)
	mm	mm	mm	mm	mm	kN
STN250-K <sub>2</sub>	250	45	40	26	65	350
STN250-K <sub>2</sub> A <sub>1</sub>	250	60	40	26	80	560
STN250-K <sub>2</sub> A <sub>2</sub>	250	62	60	30	80	600
STN250-K <sub>2</sub> A <sub>3</sub>	250	60	40	26	80	560
STN250-K <sub>2</sub> A <sub>4</sub>	250	60	44.3	29.7	90	600
STN250-K <sub>2</sub> A <sub>6</sub>	250	45	40	26	70	350
STN315-K <sub>2</sub>	315	65	44	30	90	1500
STN250	250	55	50	25	70	350
STN250A	250	60	54	36	90	600

链号	h <sub>1</sub>	F	E <sub>1</sub>	d <sub>1</sub>
Chain No.	mm	mm	mm	mm
STN250-K <sub>2</sub>	59.5	70	80	14
STN250-K <sub>2</sub> A <sub>1</sub>	70	85	80	14
STN250-K <sub>2</sub> A <sub>2</sub>	72	90	85	16
STN250-K <sub>2</sub> A <sub>3</sub>	70	85	80	14
STN250-K <sub>2</sub> A <sub>4</sub>	70	85	80	14
STN250-K <sub>2</sub> A <sub>6</sub>	60	70	80	14
STN315-K <sub>2</sub>	60	267/2	55	方
				Square Hole
				12.7
STN250	70	80	80	18
STN250A	70	85	80	14